



exivo:
Simply Access Control

Simple.
Convenient.
Customised.



Team exivo presents: Convenient access control. Easy security. Customised solutions

"EXIVO IS THE PERFECT SOLUTION IF YOU WANT TO EASILY AND RELIABLY DEFINE WHO IS ALLOWED ACCESS TO SPECIFIC DOORS AT SPECIFIC TIMES. LEAVING YOU TO FOCUS ON THE JOB AT HAND."

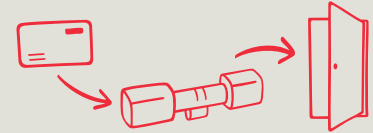

Tom is our man of action

always on the lookout for pragmatic practical solutions to enhance security. He's confident: "I am yet to be shown a door we cannot secure."



Marc loves bits and bytes

and is our IT specialist. What can't be controlled over his smartphone simply doesn't exist. He's confident: "We only continue using things if they work simply."

"SOME SECURITY REQUIREMENTS NEED A SINGLE ACCESS SOLUTION. EXIVO DOES THE JOB FAST AND WITH EASE."

"THE LONG-STANDING SECURITY TECHNOLOGY AND INDUSTRY LEADER DORMAKABA PRESENTS EXIVO, A CUSTOMISED ACCESS SOLUTION FOR SMALL TO MEDIUM SIZED BUSINESSES."

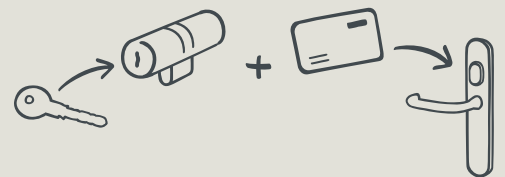

Sarah is the expert organiser

in the exivo team. She is a shining example of efficiency and accounting discipline. Her take on things: »Security is our most valuable asset, but it doesn't necessarily mean that the security solutions have to be expensive!«

We – the exivo team– stand for exivo's key qualities: easy planning and assembly, convenient hassle-free operation and a predictable transparent billing and service model. exivo is a system, that has been developed through the knowledge gained from many years of international experience as a provider of industrial access solutions.

Ensuring your company can also benefit easily from the security, convenience and flexibility of holistic access control.

Would you like to know more about exivo?

Then simply visit our website www.dormakaba.com/exivo. We look forward to hearing from you.

The exivo team

exivo:

New. Different. Secure. And, first and foremost: very easy and convenient

Do you have a feeling that your premises are not secure enough? Do you know everyone who has a key? Do you have people who should have restrictive access but not every day and not at any time.

Maybe you have areas that need to be specially protected, because of sensitive data, customer files, restricted substances, or special security requirements? Or do you just want to go home after work with an easy mind?





No matter what your security motivation is and what an access solution needs you have – with exivo one thing is sure: it will all be easy and convenient.

Critical doors are secured and monitored by electronic and wireless locking components in proven dormakaba quality. Complete control over access media ensures maximum security and flexibility. Access rights can be changed or cancelled for individual employees at any time. All other doors are secured as usual with keys and mechanical locking systems, which can also be managed over exivo system.



exivo is run over the web-based exivo platform, accessible to you and, if necessary, your exivo partner. You decide which tasks you wish to manage yourself and which should be hosted by your exivo partner.

No server, additional computer or software are required on site. We developed exivo especially for companies that need an access solution, but don't want to waste time on managing it. After all, you prefer to focus on your core

business – and not on organising access control solutions. Even if your exivo partner manages everything for you, you will always have full cost control with no unpleasant surprises – thanks to fixed running and service rates.



So simply:
overview of six benefits



Easy planning.
Fast assembly

✓ page 8

1

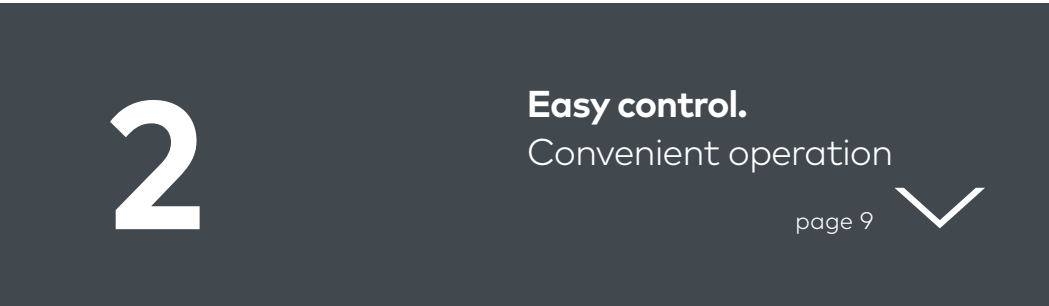

Easy control.
Convenient operation

page 9 ✓

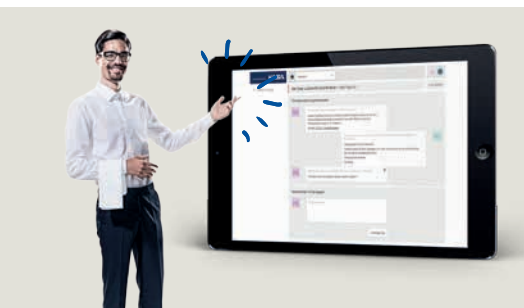

Easy service.
Fast solution

✓ page 10

3

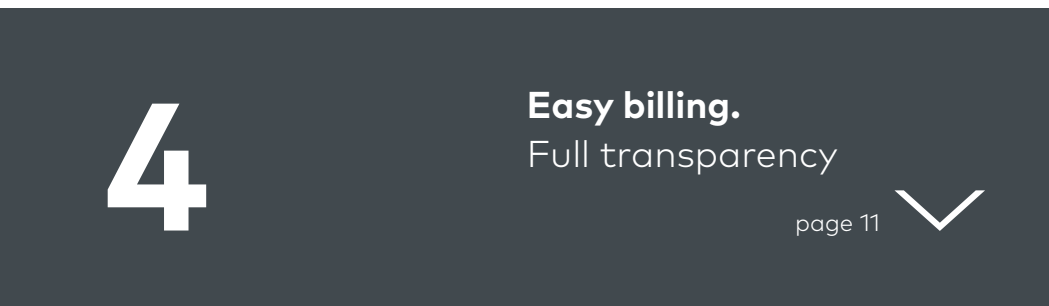

Easy billing.
Full transparency

page 11 ✓

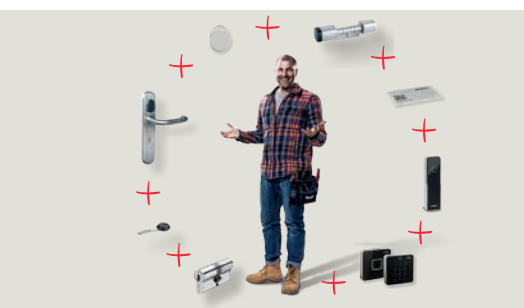

Easy expansion.
Comprehensive security

✓ page 12

5

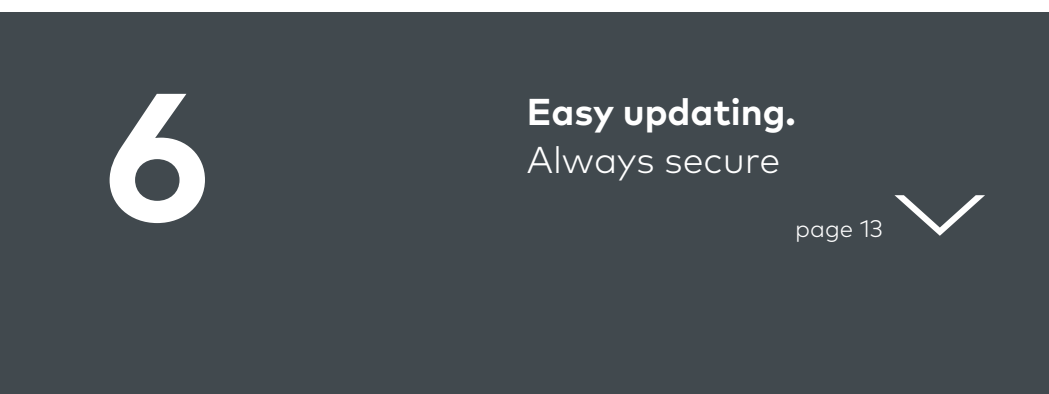

Easy updating.
Always secure

page 13 ✓



1

Easy planning. Fast assembly

- Easy planning and configuration over the web-based exivo platform
- Fast installation with no interruption of daily business
- Straightforward commissioning - thanks to the central exivo platform no special software or server is necessary on site

Directly after you place your order, your assigned exivo partner can set up the system »digitally« before it is even installed. It's very simple thanks to the central exivo platform. Simply upload layout, insert components, create users and assign rights. Your system is ready to go as soon as the components are installed. Security couldn't be simpler or faster.

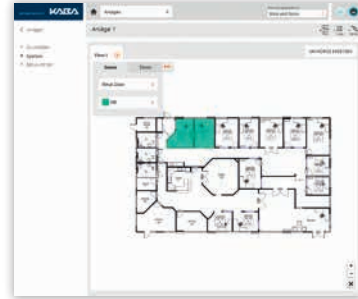



2

Easy control. Convenient operation

- Hassle-free 'full-service' operation by your exivo partner or do-it-yourself.
- Assign and change rights over the easy to use exivo platform
- Access anywhere there is internet access and have complete control over smartphone, tablet PC or computer

New users created, user rights amended even while the system is active All over the convenient and user-friendly over the central exivo platform based in the cloud with no software installation required.

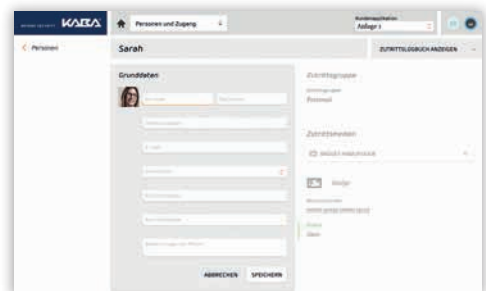

3

Easy service. Fast solution

- Easily send service requests to your exivo partner over the exivo online platform
- Straightforward communication with exivo partner over the integrated online support messenger
- Automatic component status messages for early service intervention
- Direct access to component fault messages by the exivo partner and remote trouble-shooting possibilities

If a question crops up or fault has to be remedied – no problem. Thanks to the integrated support messenger you have a hot wire to your exivo partner, who can also supply, remote support immediately over the central exivo platform. The exivo platform even lets your exivo Partner know in advance about upcoming service issues, like battery replacement.



Zeitraum	Status	Titel	Erreichte
25. Nov. 2020 10:28:07	Zuletzt geändert, aber nicht genehmigt	Wass. Maschine	1000 07 28 0000 0000
25. Nov. 2020 14:30:20	Zuletzt bearbeitet	Julius. Maschine	1000 07 28 0000 0000
25. Nov. 2020 14:30:20	Zuletzt nicht genehmigt	Wassermisch. Maschine	1000 07 28 0000 0000
25. Nov. 2020 14:30:23	Zuletzt bearbeitet und genehmigt		
25. Nov. 2020 14:30:07	Zuletzt bearbeitet	Julius. Maschine	1000 07 28 0000 0000
25. Nov. 2020 14:30:09	Zuletzt bearbeitet	Tom. Maschine	1000 07 28 0000 0000
25. Nov. 2020 14:30:52	Zuletzt bearbeitet und genehmigt		
25. Nov. 2020 14:27:09	Zuletzt bearbeitet	Tom. Maschine	1000 07 28 0000 0000
25. Nov. 2020 14:37:49	Zuletzt nicht genehmigt	Katja. Maschine	1000 07 28 0000 0000





4

Easy billing. Full transparency

- Low initial investment so it doesn't break the budget
- Predictable expenditure due to the same monthly costs
- Fair cost structure as you only pay for what you need

And you decide exactly what you need. And that is what you pay for – no more and no less. Your fixed costs stay the same. So you enjoy full transparency and cost control.





5

Easy expansion. Comprehensive security

- Easy expansion and upgrading as the system will develop, along with the company
- Retrofits for every door and other lock types
- Integrated key and mechanical lock management
- Integrated management of keys, cards and other access media and their users
- exivo can even manage the mechanical key systems of our providers

Building changes due, for instance a new security requirements, new doors or company expansion no problem. exivo can be simply extended at any time. Not only by electronic locking components, but also mechanical locks where practicable. These locks and keys are also managed very simply over the exivo platform.



6

Easy updating. Always secure

- Ongoing development of the web-based exivo platform will include functionality upgrades
- Immediate availability of updates over the automatic update function of the central exivo platform
- Maximum security thanks to the exivo platform central management system on secure protected servers

What's nice about exivo: no server, no additional computer and no other software are required on site. Everything runs over the central exivo platform. It ensures that you always benefit from all new functions and updates. So security measures are also continuously and automatically updated.

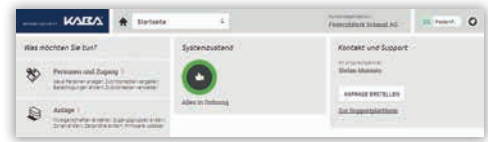

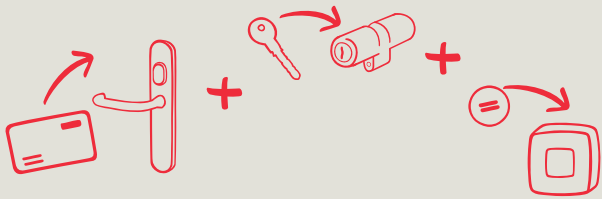

Card operation

Key operation

RFID chip operation

What your employees get out of exivo:

- ease of use and free choice of media
- user friendly operation
- lost keys are no problem
- rights can be adjusted at short notice, for instance when someone has to enter the premises outside business hours or temporary employees, visitors etc. need to be granted access rights

1



dormakaba is behind them all:

- we supply complete access control infrastructures
- we ensure that systems are up-to-date in terms of functions and security
- we offer the experience of a technology leader with more than 150 years' experience in security technology
- we offer electronic, and mechanic locking systems
- we manufacture standardised access media like keys (electronic or not), ID cards or RFID chips



Electronic C-Lever



Access Wall reader



Digital cylinder



Mechanical cylinder



RFID chip



ID cards



Keys

4

2

What you get out of exivo as an entrepreneur:

- access control system without additional software or server
- easy and intuitive operation
- full support and co-ordination by exivo partner
 - system always up-to-date in terms of functions and security, no expense entailed at all
 - freely choose the amount of control you or your exivo partner should have
 - cost control and transparency
 - fixed costs with no unpleasant surprises

It's as simple as this

The exivo platform takes care of everything:

- the centrepiece of exivo
- under continuous development
- always up to date including state-of-the-art security technology



Operation by notebook, tablet PC or smartphone

3

What your exivo partner does:

- plans and maintains your system over the exivo platform
- hosts the entire operation if you wish
 - is always available to help and advise
 - Available to remotely troubleshoot via online chat support



exivo: How a solicitor's firm secures its data



"Protecting our clients is our first priority. This ranges from case documents and files to important pieces of evidence. These and valuable items all have to be reliably protected from unauthorised access. Yet we have to be flexible enough to grant our external cleaning company or temporary staff straightforward entry to the premises. exivo offers all these possibilities and is therefore the right choice for us."



Desktop PC



Smartphone



Laptop



Tablet

exivo platform

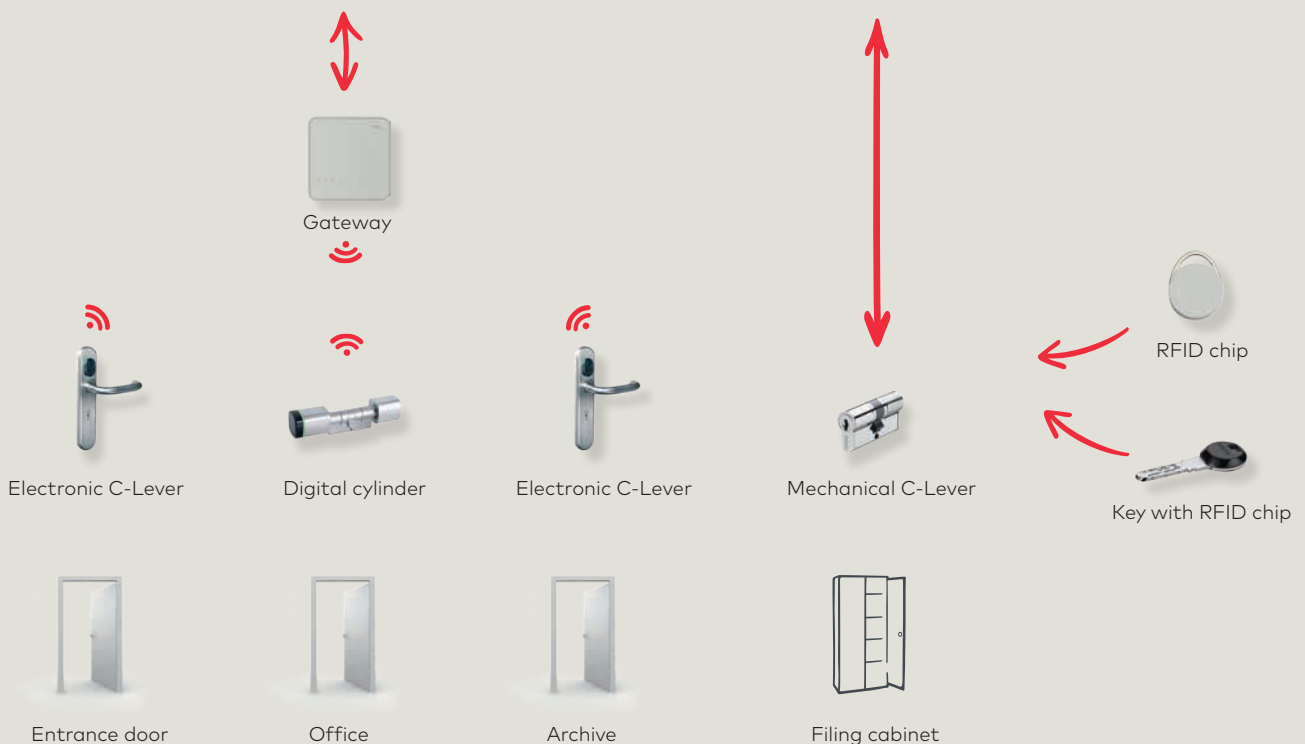

Authorised access for: 4 solicitors, 2 partners, 2 assistants, external cleaning company. Area: 210 m²

exivo:

How a pharmacy secures its medicine

"Our access control was faced with a major challenge: controlling shop opening hours at the customer entrance, controlling after-hour deliveries, the night-time counter – and at the same time affording easy lab access to trained personnel while protecting expensive equipment, medicine and substances from unauthorised personnel. exivo has at last brought greater order and security to the entire organisation. We couldn't be happier."



Desktop PC



Smartphone



Laptop



Tablet

exivo platform

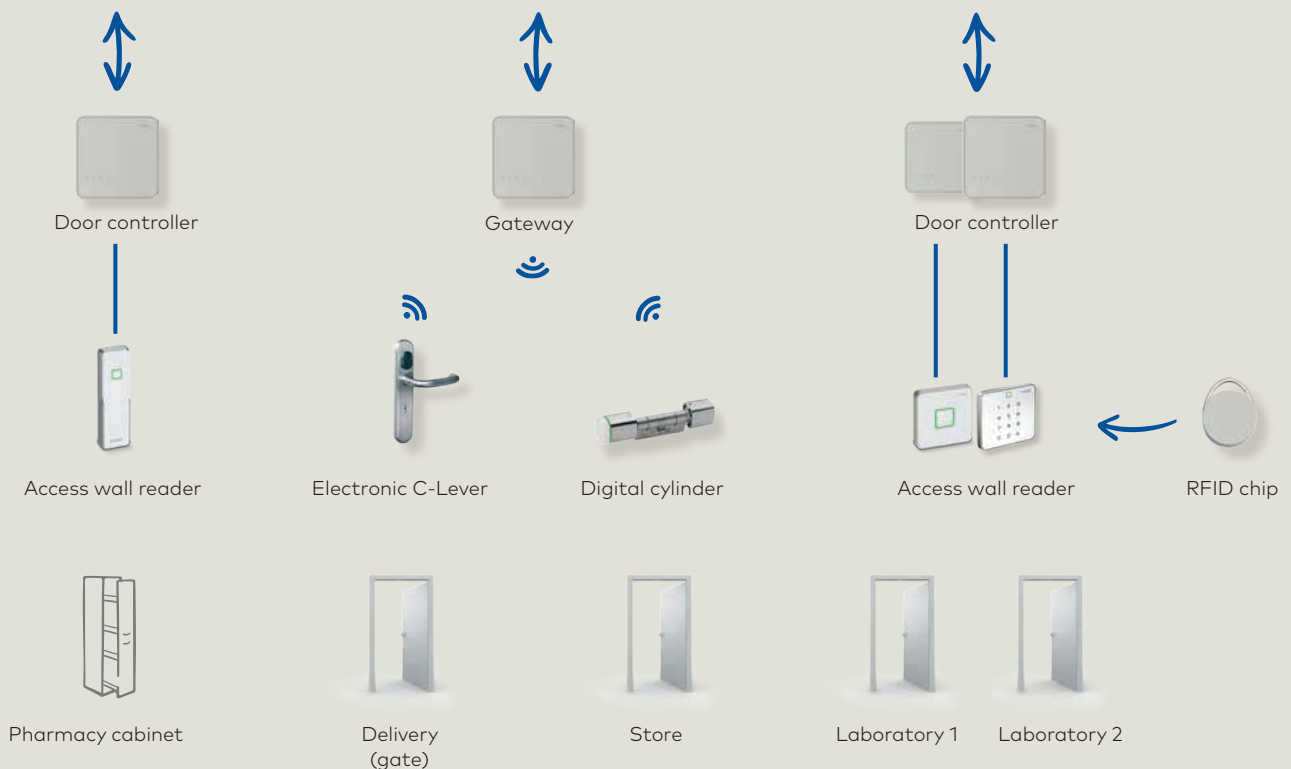

Authorised access for: 2 pharmacists, 4 assistants, external cleaning company. Area: 310 m² (store and warehouse)

exivo:

How a doctor's surgery secures its labs



"Besides medicine, chemical and biological substances and sources of radiation for medical applications we also have to keep expensive equipment and confidential patient information under lock and key. We are obliged to do so by law. It's no easy task with all the patients and suppliers that come and go every day. exivo exceeded our expectations."



Desktop PC



Smartphone



Laptop



Tablet

exivo platform

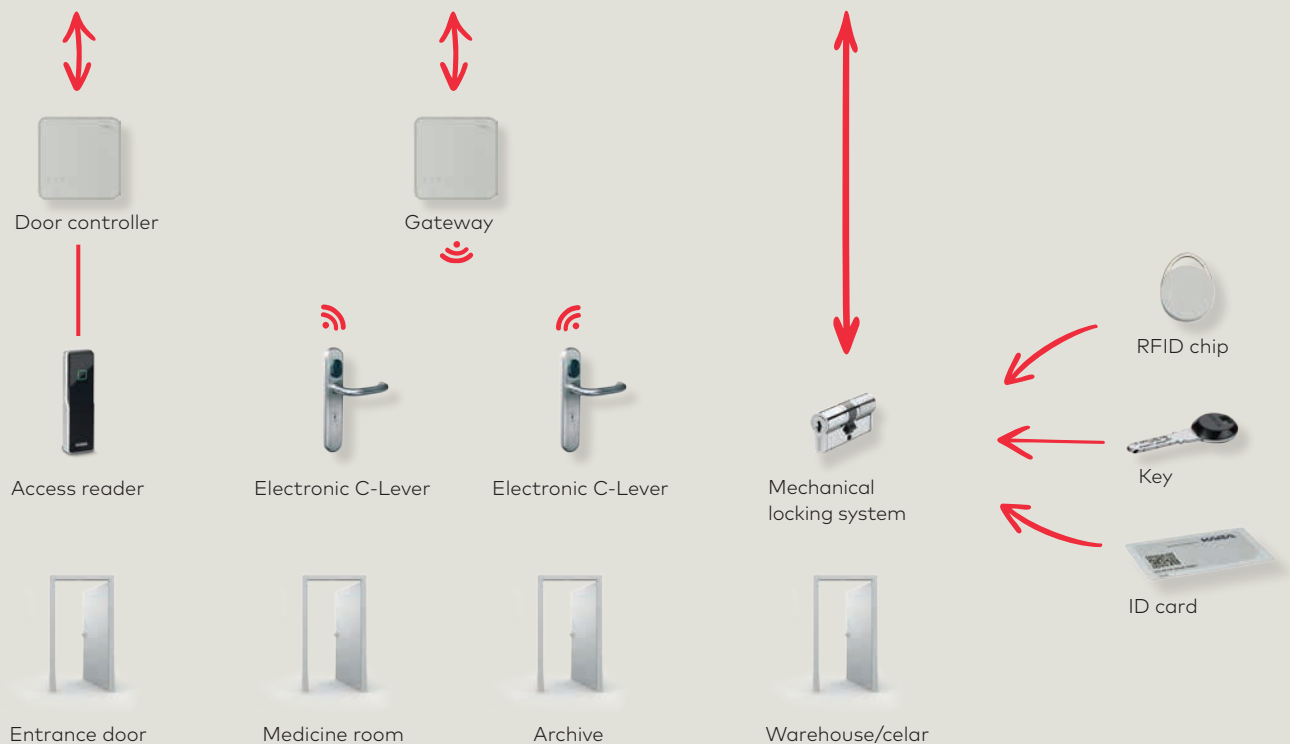

Authorised access for: 2 doctors, 6 part-time doctor's receptionists, 2 external cleaning company. Area: 250 m²

exivo:

How an advertising agency secures its ideas

"exivo was just what we were looking for. It's like Piccadilly Circus here and working project defined hours, they can be pretty irregular. So when we're busy we work longer hours and are helped out by freelancers, who come and go within the office. Along with the standard parcel services, external service providers and clients. It's all got to be well and securely organised. exivo offers us this flexibility without too much trouble and is therefore the ideal system for our agency."



Desktop PC



Smartphone



Laptop



Tablet

exivo platform

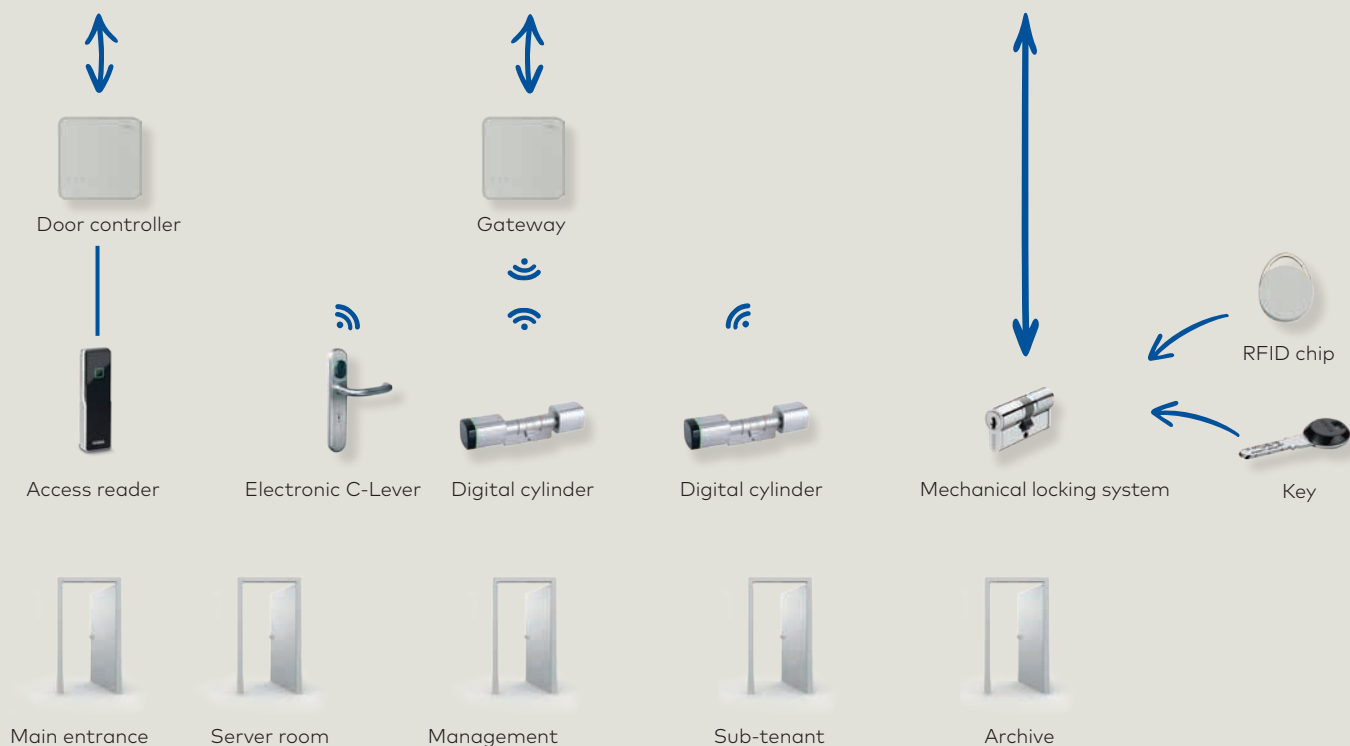

Authorised access for: 2 MDs, 14 employees, various freelancers, external cleaning company. Area: 510 m²



So simply:
**Five steps to your
access control**

Step 1: **Get in touch**

Visit our home page at dormakaba.com/exivo and complete our brief contact form in a couple of seconds. We can then locate a suitable exivo partner near you.



1



2

Step 2: **Your exivo partner calls you**

A selected local exivo partner will call you to make an appointment, to go through initial planning with our exivo platform. Your exivo partner may be able to provide you with a rough estimate at this stage depending on the circumstance.



Step 3: **Your offer**

You will receive a personal cost breakdown to peruse at your convenience. Only once everything is planned to your satisfaction do you place the project in your exivo partner's hands.



3



4

Step 4: **Delivery and installation**

Your exivo partner takes care of system delivery and installation. You don't have to lift a finger and can get going right away. As soon as you place your order you can set up your access in the live system.

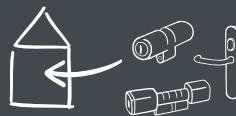

Step 5: **Get secure, stay flexible**

You can relax safe in knowledge that if you need help or assistance your exivo partner and us are on hand to supply it.



5

exivo:

You have questions. We have the answers

Do I need hardware and special software for exivo?

You need exivo door components on the doors and Internet access. You don't need software, because exivo runs quite simply over your web browser.

Where can I get more information about exivo?

Visit us at dormakaba.com/exivo, talk to your exivo partner or get in touch with us personally. We'll be happy to assist you.

I don't have much staff fluctuation. Isn't exivo too complex for me?

exivo is so simply structured, operation is easy and intuitive. If you like you can hand over management completely to your exivo partner. They make any changes as required, leaving you to concentrate fully on your business.

I'm on the road a lot. Can I still operate the system?

exivo was designed especially for this situation. All you need is Internet access. Over a computer, tablet PC or smartphone: you can access the system whenever and wherever you like.





I can't do any wiring on my premises.

Is that a problem?

No. exivo offers various wireless products for these doors. A wireless gateway is simply installed close to the door components, so they are also integrated into the system wirelessly.

I've lots of doors, but I only need to secure one. Is that ok?

Sure. exivo works from one door onwards. The system can be easily extended as the situation demands.

How long does it take to install and commission exivo?

As the system is already available during planning, it can be set up at an early stage. We get it going as soon as you place your order. That means once the products have arrived, installation can be less than a day depending on size, and you will be up and running.

What do I do if I have problems with a door?

exivo is designed to prewarn your partner of problems occurring with the systems intuitive maintenance cycles. In the unlikely event of a problem arising on a door without prior notice, the system will pick it up and notify the chosen system user automatically. Depending on the service model, the fault is sent directly to your exivo partner or yourself as system user.

Who is exivo designed for?

Small to medium sized businesses looking for a hosted solution to their access control system with minimal internal IT co-ordination. exivo's intuitive flexible user interface, designs access to buildings, rooms and infrastructure and is very easy and user-friendly in the process.

I have a need for something like this. But what will it cost me?

exivo is a service billed monthly with the same agreed amount with no unpleasant surprises. There are no high costs for software, programming tools or the IT infrastructure. You only pay for what you need.

Can I choose the service level myself?

Yes. exivo offers different service packages. You select the functions and services you need.



Authorised specialist partner

dormakaba
Deutschland GmbH
DORMA Platz 1
58256 Ennepetal
T: +49 2333 793-0
F: +49 2333 793-49 50
www.dormakaba.com